

VICINITY MAP
NTS

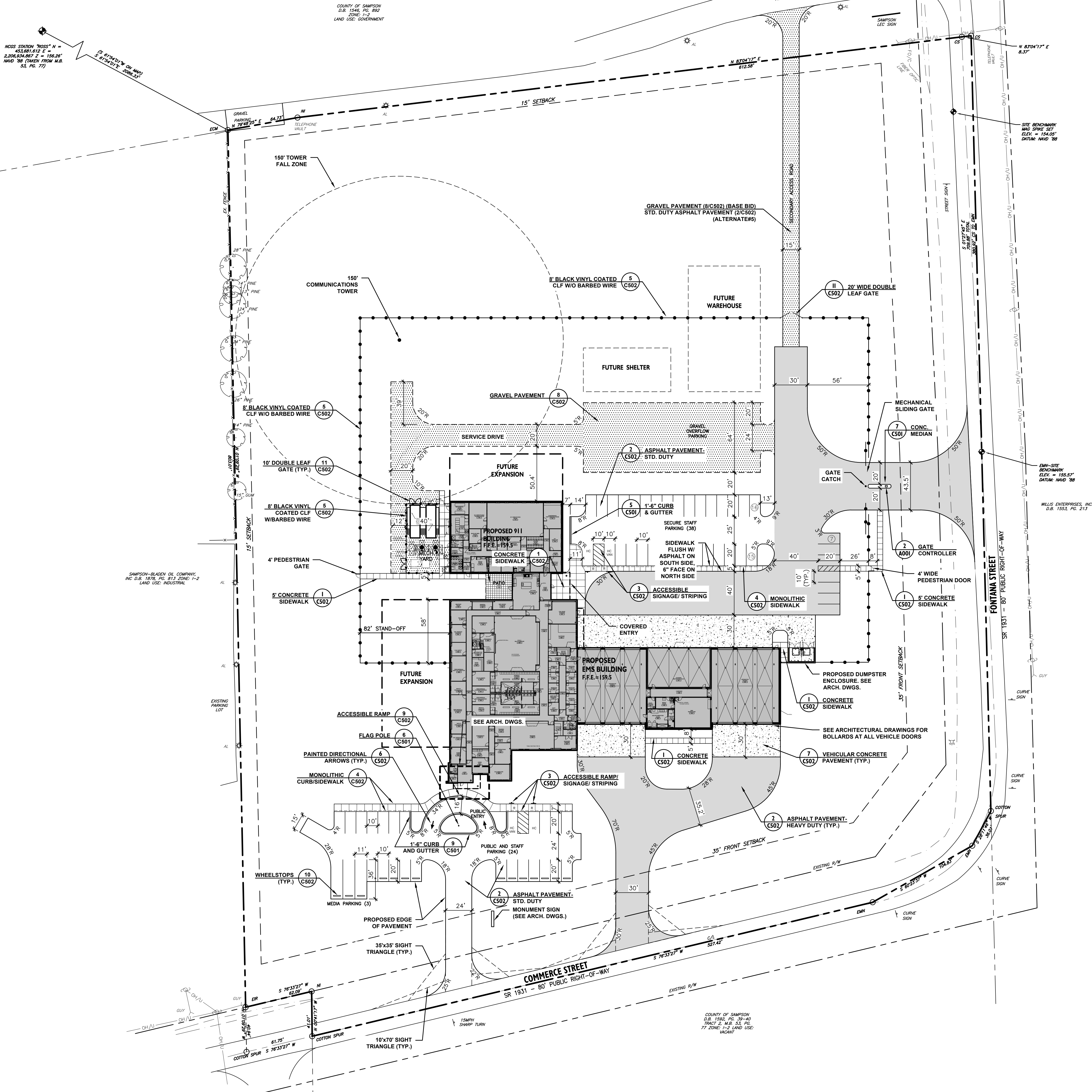

SITE NOTES

- DIMENSIONS AND COORDINATE POINTS ARE TO FACE OF CURB, EDGE OF PAVEMENT, OR CORNER OF BUILDING UNLESS OTHERWISE NOTED.
- ALL IMPROVEMENTS AND CONSTRUCTION SHALL BE IN ACCORDANCE WITH STATE AND LOCAL STANDARDS.
- ANY DISCREPANCIES FOUND IN THE FIELD SHALL BE CALLED TO THE ATTENTION OF THE ARCHITECT PRIOR TO PROCEEDING WITH WORK.
- PRIOR TO BEGINNING CONSTRUCTION, UNLESS OTHERWISE PROVIDED IN THE CONTRACT DOCUMENTS, THE CONTRACTOR SHALL SECURE AND PAY FOR ALL PERMITS (BOTH SITE AND BUILDING RELATED) INCLUDING BUT NOT LIMITED TO REGULATORY FEES, LICENSES, AND INSPECTIONS NECESSARY FOR PROPER EXECUTION AND COMPLETION OF THE WORK.
- THE GENERAL CONTRACTOR SHALL CONTACT ALL OWNERS OF EASEMENTS, UTILITIES, AND RIGHT-OF-WAYS, PUBLIC AND PRIVATE, PRIOR TO WORKING IN THESE AREAS.
- GENERAL CONTRACTOR SHALL MAINTAIN THE SITE IN A MANNER SO THAT WORKMEN AND THE PUBLIC SHALL BE PROTECTED FROM INJURY.
- SIGHT TRIANGLES SHOWN ARE THE MINIMUM REQUIRED.
- USE CAUTION WHEN REPRODUCING COPIES OF THE CONSTRUCTION DRAWINGS. COPIES ARE SUBJECT TO DISTORTION AND INACCURACY IN THE SCALE OF DRAWINGS. VERIFY ANY DISCREPANCIES WITH BENESCH.
- ALL SIGNS, PAVEMENT MARKINGS, AND OTHER TRAFFIC CONTROL DEVICES SHALL CONFORM TO THE MANUAL ON UNIFORM TRAFFIC CONTROL DEVICES (MUTCD), LATEST EDITION AS AMENDED.
- ALL PAVEMENT MARKINGS SHALL BE FOUR (4) INCHES WIDE UNLESS INDICATED OTHERWISE ON THE DRAWINGS.
- CONTRACTOR SHALL FURNISH AND INSTALL ALL PAVEMENT MARKINGS AS SHOWN ON THE PLANS.
- CONTRACTOR SHALL SAW-CUT EXISTING ASPHALT PAVEMENT AREAS TO TIE IN SMOOTHLY TO PROPOSED PAVEMENT AT DRIVEWAY ENTRANCES.
- REFER TO ARCHITECTURAL PLANS FOR ACTUAL BUILDING DIMENSIONS.
- THE ENGINEER WILL PROVIDE THE CONTRACTOR WITH AN ELECTRONIC FILE OF THESE DRAWINGS UPON REQUEST. RELEASE FORM REQUIRED.
- CONTACT THE UTILITY COMPANY TO RELOCATE ANY EXISTING UTILITY POLES. ALL EXISTING FACILITIES WHICH CONFLICT WITH THE IMPROVEMENTS UNDER THE SCOPE OF THIS PROJECT MUST BE RELOCATED AT THE EXPENSE OF THE OWNER.
- STOP BEFORE YOU DIG. CALL 811. IT'S THE LAW.
- HEAVY DUTY PAVEMENT SHOWN ON THIS PLAN IS CAPABLE OF SUPPORTING AN 80,000 LB FIRE TRUCK.
- ALL ROAD IMPROVEMENTS AT COMMERCE STREET & FONTANA STREET TO BE COORDINATED WITH CITY ENGINEERING DEPARTMENT PRIOR TO CONSTRUCTION.

LEGEND

EXISTING SIGN	EXISTING CURB AND GUTTER
PROPOSED SIGN	PROPOSED CURB AND GUTTER
EXISTING IRON PIN	PROPOSED FLUSH CURB AND GUTTER
EXISTING LIGHT POLE	PROPERTY LINE
EXISTING UTILITY POLE	EXISTING EASEMENT
RIGHT-OF-WAY	EXISTING FENCE
ACCESSIBLE SPACE	PROPOSED FENCE
EXISTING TREE TO REMAIN	EXISTING OVERHEAD UTILITY LINE
EXISTING FIRE HYDRANT	PROPOSED STANDARD DUTY ASPHALT PAVEMENT
# OF PARKING SPACES	PROPOSED HEAVY DUTY ASPHALT PAVEMENT
CENTERLINE	PROPOSED GRAVEL PAVEMENT
ACCESSIBLE RAMP	PROPOSED VEHICULAR CONCRETE PAVEMENT
PROPOSED BOLLARD	

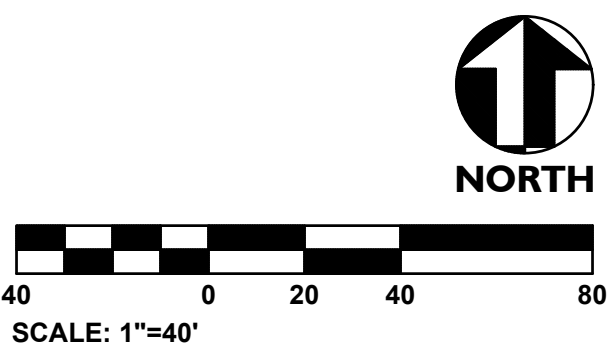

SAMPSON COUNTY
911 & ES
FACILITIES

CLINTON,
NORTH CAROLINA

CONSTRUCTION
DOCUMENTS

SITE PLAN

DATE	12.04.2020	
PROJECT NO	20003	
REVISIONS		
NUM.	DATE	DESCRIPTION:

THIS DRAWING IS THE PROPERTY OF ADW ARCHITECTS, P.A. AND SHALL NOT BE REPRODUCED OR COPIED IN WHOLE OR IN PART. IT SHALL NOT BE USED ON ANY OTHER PROJECT OR GIVEN TO ANY OTHER COMPANY OR AGENCY WITHOUT THE CONSENT OF ADW ARCHITECTS, P.A.



SEAL

C200

SHEET NUMBER